

ANEP BOX TA

EMERGENCY TELEPHONE FOR LIFTS

SCALABLE VOICE COMMUNICATION AND MULTI-ELEVATOR INTERCOM SYSTEM

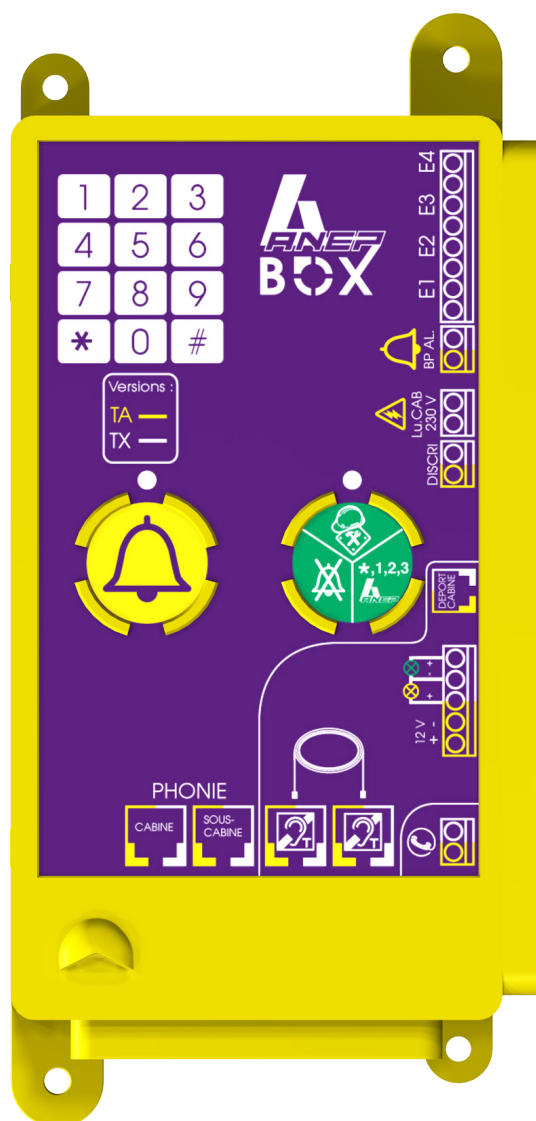

TABLE OF CONTENTS

1 - <u>GENERAL</u>	P.5
1.1 - Technical Specifications	
1.2 - Connections & BOX TA Peripherals	
2 - <u>FEATURES</u>	P.7
2.1 - Telephone Network Selection	
2.2 - Cabin alarm	
2.2.1 - Cabin Alarm Discrimination	
2.2.2 - Discrimination according to EN81-28 Standard	
2.2.3 - Simple Discrimination	
2.2.4 - Forced Alarm	
2.2.5 - Sound Level Settings	
2.2.6 - DTMF Code Transmission Level Adjustment	
2.2.7 - Communication Duration	
2.2.8 - Operator Acknowledgment	
2.2.9 - End of Alarm	
2.3 - Periodic Call	
2.4 - Data Transmission Monitoring	
2.5 - Automatic Hang-up	
2.6 - 12V & Battery Monitoring	
2.7 - <u>Battery Monitoring for GSM gateway Models ANEP</u>	
2.8 - P100 Protocol	
2.9 - Machine Room Intercom (Firefighters)	
3 - <u>INSTALLATION</u>	P.12
3.1 - Prerequisites before commissioning	
3.2 - Installation Steps	
3.3 - Pendant Cable	
3.4 - Installation / Connections	
4 - <u>YELLOW / GREEN INDICATOR CONNECTION</u> (if MIDIS not present)	P.13
4.1 - <u>Programming of Yellow & Green LEDs according to EN81-28 standards (2003 or 2022)</u>	
5 - <u>PROGRAMMING</u>	P.15
5.1 - Factory Configuration	
5.2 - Programming Mode	
5.2.1 - Access to Programming	
5.2.2 - Exit Programming Mode	
5.3.3 - Programming Access Code Modification	
5.3 - Telephone Network Selection	
5.3.1 - Analog Mode	
5.3.1.1 - Analog Mode (PSTN / RTC line)	
5.3.1.2 - Analog Mode (Private PBX)	
5.3.2 - GSM Mode	

- 5.4 - Transmitter Number Programming (or Identifier / PROM)**
- 5.5 - Module Number Addressing Programming**
 - 5.5.1 - Addressing for Grouping on Analog Line
 - 5.5.2 - Addressing for Grouping on GSM Gateway
- 5.6 - Communication Protocol**
- 5.7 - Alarm Identification Method**
- 5.8 - Telephone Number Programming**
 - 5.8.1 - Telephone Number Table
 - 5.8.2 - Telephone Number Programming
 - 5.8.3 - Pause Programming
 - 5.8.4 - Delete a Number
- 5.9 - Parameter Validation and Settings**
 - 5.9.1 - 12V Monitoring Configuration
 - 5.9.2 - Cabin Alarm Button Press Delay
 - 5.9.3 - Trapped Passenger Call Acknowledgment (EN81-28)
 - 5.9.4 - Communication Duration
 - 5.9.5 - DTMF Code Transmission Level Adjustment
 - 5.9.6 - Sound Level Adjustment
 - 5.9.7 - "Dual Call" Mode Configuration
- 5.10 - Periodic Call**
 - 5.10.1 - Enabling the Periodic Call
 - 5.10.2 - Periodicity of the Periodic Call
- 5.11 - Intercom**
 - 5.11.1 - Gain Settings in Machine Room and Firefighter Intercom Mode

6 - OPERATION

P.25

- 6.1 - Cabin Alarm Test**
- 6.2 - Technician Alarm on Cabin Roof**
- 6.3 - Automatic Hang-up (Voice Mode)**
- 6.4 - Call Number Sequence**
 - 6.4.1 - Standard Mode
 - 6.4.2 - Dual Call Mode

7 - KEYPAD PROGRAMMING TABLE

P.27

RECOMMENDATIONS

This documentation is intended for trained professionals experienced in the elevator industry.

Accordingly, when working on an elevator to install **ANEP** equipment, all industry-specific safety rules must be strictly followed.

- Use appropriate **Personal Protective Equipment (PPE)**
- De-energize the installation before performing any **electrical connections**
- Ensure personal safety before working in the **hoistway**

 **Before handling any ANEP devices, make sure they are completely powered off.**

For all **ANEPBOX** equipment (TA, TA+, TX, TX+, etc.), it is essential to **connect all peripherals before connecting the telephone line.**

WARRANTY

This product is covered by a **3-year warranty** from the date of invoicing, **except for batteries and cells**, which are covered for **6 months**.

However, this warranty does not apply in the following cases :

- Use **not in accordance with the instructions** in this manual.
- Damage caused by **external factors** (vandalism, fire, flood, storm, overvoltage, etc.).
- Installation performed by an **unqualified or non-authorized installer**.
- Modifications or repairs carried out by **non-authorized entities**.
- Opening of the product by a **person not authorized by ANEP**.



Electrical equipment must be recycled in accordance with Directive No. 2012/19/EU of 04/07/2012 on Waste Electrical and Electronic Equipment (WEEE).

1 - GENERAL

1.1 - Technical Specifications

STANDARDS

- Compliant with European standards **EN81-28** and **EN81-70** (2018 / 2022)
- Compliant with European standard **EN81-70** (2003)
- Compliant with Directive 95/16/EC
- Compliant with ETSI ES 203 021-1 v2.1.1 (2005-06)

INSTALLATION LOCATIONS

- Mounted on cabin roof
- Installation in elevators, goods lifts, hoists, etc.

ALARM FUNCTIONS

- Integrated or remote voice modules
- Triphony function with addition of **BOX-SC** or **BOX-C** modules
- Cabin alarm discrimination
- Trapped passenger alarm acknowledgment
- Cabin and under-cabin voice modules
- Technician alarm on cabin roof
- Dual call to two contacts
- Volume and acoustic adjustment (local or remote)

POWER SUPPLY

- Line-powered for voice calls
- 12V power supply: for hearing loop (BIM), yellow/green indicators

TELEPHONE NETWORK

- Connection to analog telephone line or GSM gateway (possible via private branch exchange – PBX)
- Triphony telealarm function backed up by the telephone line (telephone-powered telealarm)
- Automatic off-hook

FEATURES

- Call location identification
- Programming via **ANEPmobile** or **ANEPprogrammation**
- 1 input from the cabin alarm button (NO or NC)
- 1 green button integrating three functions: trapped passenger alarm acknowledgment, technician arrival and departure
- 1 yellow button for technician alarm on cabin roof

TELEPHONE NUMBERS

- 6 programmable telephone numbers
- 1 backup voice number if the primary number fails
- Dual call management
- Periodic test (1, 2, or 3 days)

EXTENSIONS

- Machine room to hoistway intercom with **BOX-M** module (*Old standard NF P 82-207, 1976*)
- Main landing to cabin voice intercom with **CARRÉ POMPIER** module (*Old standard NF P 82-207, 1976*)
- Main landing to cabin voice intercom with **INTER-CAN** system (*Current standard NF P 82-207, 2018*)
- Main landing to cabin voice intercom with **IPH-CAN** module (*Current standard NF P 82-207, 2018*)

Factory Configuration

- | | |
|----------------------------|-----------|
| • Programming code : | *123 |
| • Communication duration : | 3 minutes |
| • Automatic hang-up : | Enabled |
| • Periodic test : | 3 days |

1.2 - Connections & BOX TA Peripherals

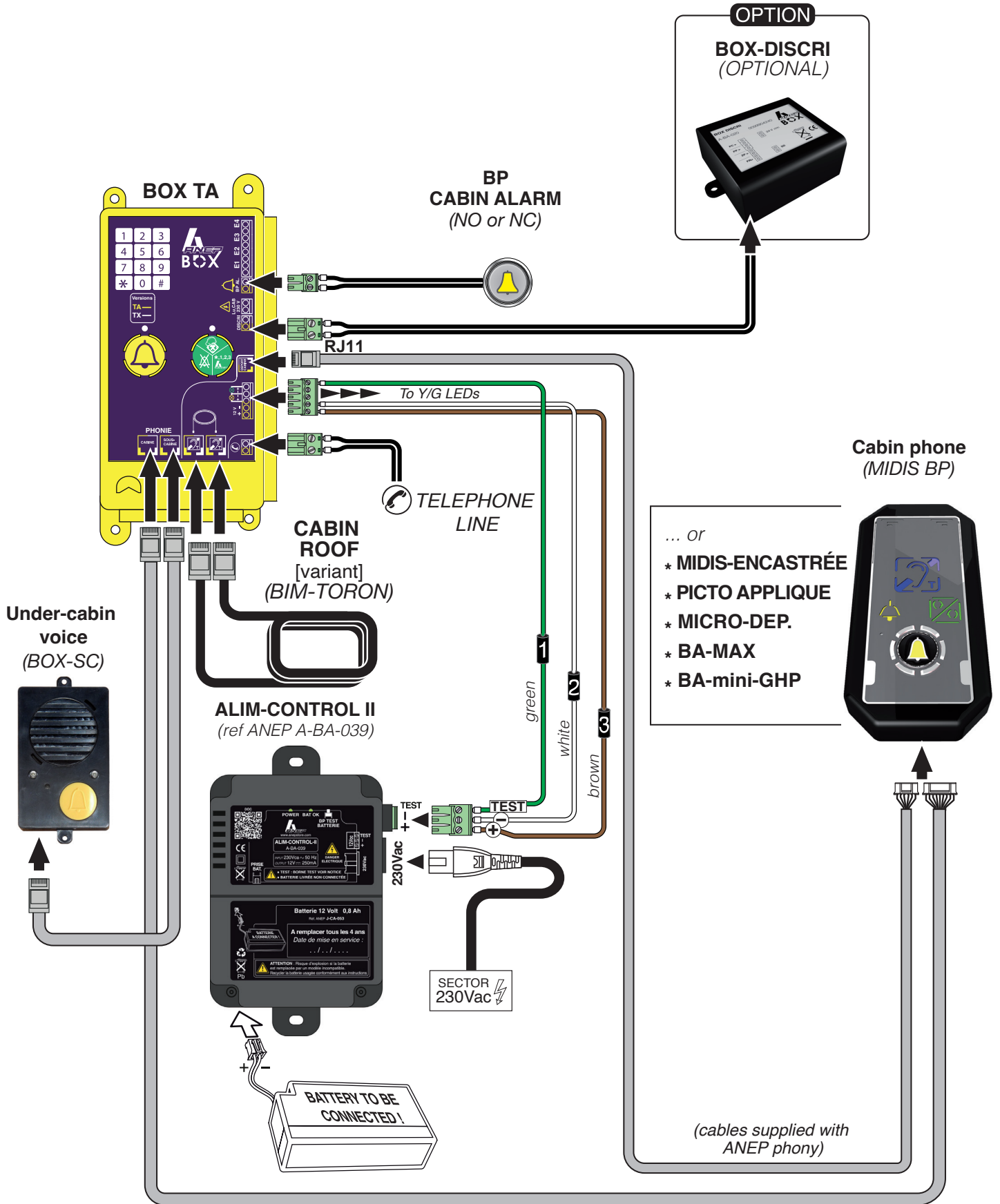

! It is essential to connect all peripherals first, then connect the telephone line, and finally the +12V power supply, if present.

2 - FEATURES

2.1 - Telephone Network Selection

The **BOX TA** module uses a telephone network to transmit alarms to a receiving center. For proper operation, it is important to specify the type of network:

- Switched telephone network (Analog PSTN / RTC)
- GSM Gateway
- PBX mode

The network selection affects the following functionalities:

- ANEP GSM gateway battery charge information
- Voice control of the speaker and microphone
- Secured data transfer to a receiving center

The PBX mode allows the **BOX TA** module to operate with most private branch exchanges, but does not guarantee compatibility with all PBXs on the market.

This mode supports :

- Dialing with line voltages at rest between 20 and 28 V
- Off-hook operation if the ring signal duration exceeds 400 ms

The **BOX TA** module is by default compatible with the various analog telephone networks used in European countries (PSTN / RTC). Only the United Kingdom (UK) requires specific programming of the **BOX TA** module.

2.2 - Cabin alarm

2.2.1 - Cabin Alarm Discrimination

Alarm discrimination is used to prevent false or unnecessary cabin alarms caused by misuse or vandalism.

A voltage of 5 V DC to 230 V AC applied to the DISCRI input of the **BOX TA** module inhibits all cabin alarm transmission.

Note: The discrimination function is only applied if the alarm end has been executed locally or remotely.

2.2.2 - Discrimination according to EN81-28 Standard

Using the BOX DISCRI add-on module installed in the machinery, discrimination analysis complies with EN81.28.

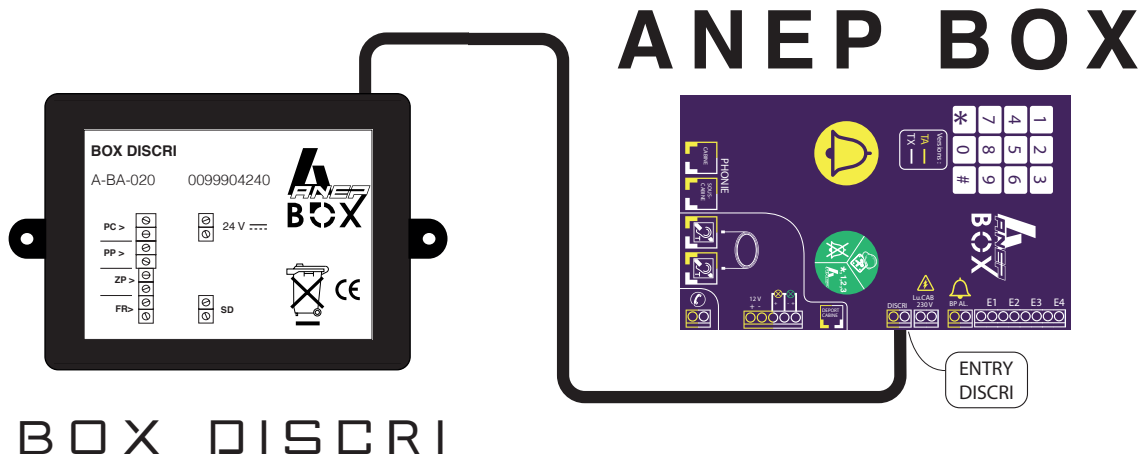

2.2.3 - Simple discrimination

It is possible to create a simplified discrimination system using autonomous information on the end of cabin door opening.

Note: Make sure the cabin door cannot be opened automatically or manually.

If the cabin is blocked between floors and the user forces and opens the cabin doors manually, the alarm will be discriminated.

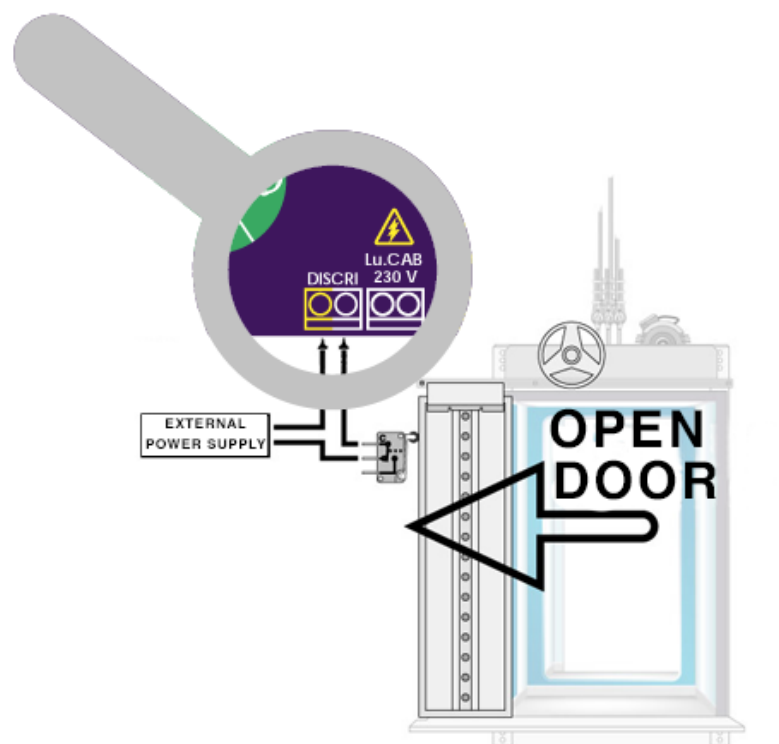

2.2.4 - Forced alarm (Safety of blocked user) (STANDARD EN 81-28 of 2018)

If there is no cabin alarm in progress and discrimination is valid, the cabin alarm can still be triggered if the key is held down for the programmed delay time (see page 27). By default, the value is approximately 30 seconds.

2.2.5 - Sound level settings

Depending on local installation conditions, it is possible to adapt the sound levels and microphone/loudspeaker toggle of the three **BOX TA** alarm points (on-cab, in-cab and under-cab). Settings are made using the **BOX TA** keypad, either off-line or during voice communication.

2.2.6 - DTMF Code Transmission Level Adjustment

DTMF code transmission power can be adjusted to match the sensitivity of different manufacturers' front-ends. The default setting is -8 dBm.

2.2.7 - Communication Duration

When an alarm is triggered, the call duration can be adjusted. This talk time can be set from **1 to 99 minutes** (factory setting = 3 minutes).



Long voice communication times can have a negative impact on the call cycle of different telephone numbers:

- for double calls,
- on completion of a message with acknowledgement mode programmed

2.2.8 - Operator Acknowledgment

When this function is enabled, the alarm must be acknowledged by the reception center operator, by dialing «#1» on the telephone keypad during voice communication.



If this acknowledgment operation is not performed, the entire call cycle for the programmed numbers will be carried out.

2.2.9 - End of alarm

Local :

A cabin alarm can only be terminated if a cabin alarm has already been triggered. When the technician presses the green button on the TA module, the alarm is terminated.

Remote :

ANEP **BOX TA** integrates the «End of user alarm triggered remotely» function. (**Standard EN81-28**)

The order is issued by the call center operator via ANEPCenter when a «User alarm blocked in cabin» has not been followed by an «End of alarm» by the on-site technician. The call center calls the **BOX TA** to give the instruction to close the user alarm. The **BOX TA** module calls the center back to inform it of the «correct» execution of the instruction and thus ensure the complete chain of alarm operation.

This function is not available if the ANEP **BOX TA** telephone line is outgoing only. After receiving this order from ANEPCenter, the BOX generates a new call with the title :

« Appearance: End of remote alarm »

The call is forwarded to a central reception unit (Telephone 104 memory)

2.3 - Periodic call

In compliance with standard EN81-28, the **BOX TA** module performs an automatic periodic test (adjustable from 1 to 3 days maximum) to ensure that the emergency call device is working properly..

2.4 - Data Transmission Monitoring

To let the technician working on the elevator know that the **BOX TA** is communicating with a central receiver, all data exchanges are audible (low level) through the **BOX TA** loudspeaker.



IMPORTANT : No action possible (during programming) on the **BOX TA** keypad during the communication phase.

2.5 - Automatic hang-up

On alarm :

Hang-up occurs automatically when the telephone line is busy or when the call time has expired. The **BOX TA** module emits a melody 10 seconds before the end of the call.

On Data transfer :

The call is automatically terminated at the end of the Data dialogue..

2.6 - 12V & Battery Monitoring

If **ALIM-CONTROL II** present and 12V control function enabled :

- The fault is transmitted after detection of a voltage below 8V for 10 minutes..
- Fault clearance is transmitted after detection of a voltage greater than 8V for 10 minutes..

If **other power supply** present and 12V control function enabled:

- The fault is transmitted after an absence of 12V voltage for 10 minutes..
- The disappearance of the fault is transmitted after the presence of 12V voltage for 10 minutes..

By default, the 12V control function is enabled..

Battery check if Alim-Control present

At the time of the cyclic call, the ANEP **BOX TA** module tests for the presence of 12V or battery if **ALIM-CONTROL II** is connected..

If no voltage is present, a «**Daily with Fault**» call is transmitted. In all other cases, the call will be a normal daily «**Periodic Test**» call.

2.7 - Battery Monitoring for GSM gateway Models ANEP

The P4GU VoLTE and PGA VoIP gateways continuously monitor their battery status. In the event of a fault, the information is transmitted to the connected **BOX TA** module.

Once the fault has been detected, the **BOX TA** module generates a call with the following title : «GSM Battery Fault Appearance».

After recharging or replacing the battery, the P4GU VoLTE or PGA VoIP gateway informs the **BOX TA** module, which generates a call with the following title : « Disappearing GSM battery fault »

Note: 2G technologies (models PG1, PG2 and PGU) and 3G (P3GU) will soon be phased out and are no longer recommended for new installations.

2.8 - P100 protocol

By default, the **ANEP** data transfer protocol (Data) is enabled (alarm location identification, date, time, cyclic test, faults, etc.).

The **BOX TA** module can be programmed to carry out these data transfers in the simplified P100 protocol format, enabling reception to a reception center equipped with this protocol.

2.9 - Machine Room Intercom (Firefighters)

The **BOX TA** module can be combined with the **BOX-M** module, adding intercom functionality between the machine room and the cab. The cab roof module and cab phone module become intercom points without any modification to the cab equipment.

3 - INSTALLATION



Before working with ANEP equipment, make sure it is de-energized.

3.1 - Prerequisites before commissioning

The operation of telephone equipment depends largely on the characteristics of the telephone line.

Particular care must be taken to ensure that the telephone line is routed in such a way as not to degrade standard technical characteristics..

Check the wiring, especially if it connects several elevator machines.



It is essential to connect all peripherals BEFORE connecting the telephone line. :

3.2 - Installation Steps

Check the wiring, especially if it connects multiple elevator machine rooms.

1. Cable type
2. Cable routing (low voltage / high voltage)
3. Interference (ventilation systems, generators)
4. Cabin alarm button
5. Cabin panel
6. Under-cabin communication
7. Telephone line (after 3 seconds, the **BOX TA** module emits one or more initialization beeps depending on the module number)
8. Backup 12V power supply (if equipped with hearing loop and yellow / green indicators)

3.3 - Pendant cable

We advise you to fit the elevator with a shielded pendant cable to ensure excellent voice quality, and to avoid any disturbances that could lead to malfunctions.

3.4 - Installation / Connections

The **BOX TA** module is installed (4 screws) on the roof of the elevator car, and must be connected to the various peripheral modules according to the desired options.

- Cabin telephony (faceplate or remote module)
- Yellow/Green pictograms
- Magnetic loop
- Under-cabin voice
- 12Vdc power supply
- BOX-DISCRI
- Telephone network

4 - YELLOW / GREEN INDICATOR CONNECTION (if MIDIS not present)

- Connect the LEDs used in the cabin according to **NF EN 81-28 (2003 or 2022)** and **EN 81-70** standards (**12V DC / 140 mA max per LED**).
- Connect a **12V DC power supply** (9 to 15V DC) of type **ALIM-CONTROL II**.

Do not make this connection if a MIDIS voice communication system is used.

Common Cathode LEDs

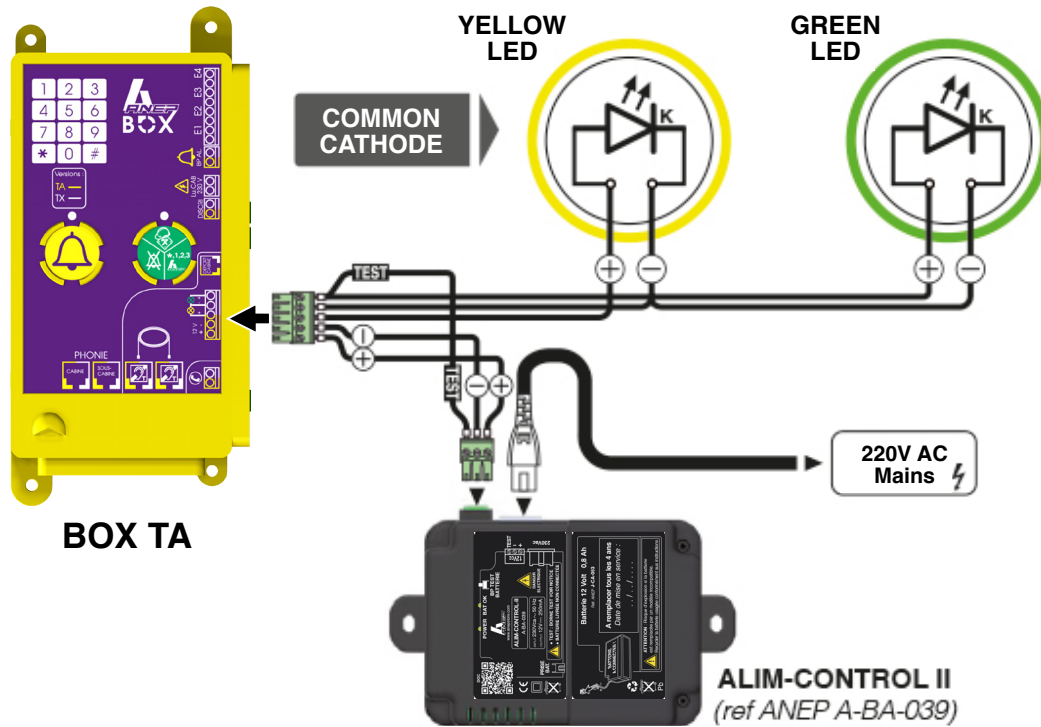

Common Anode LEDs

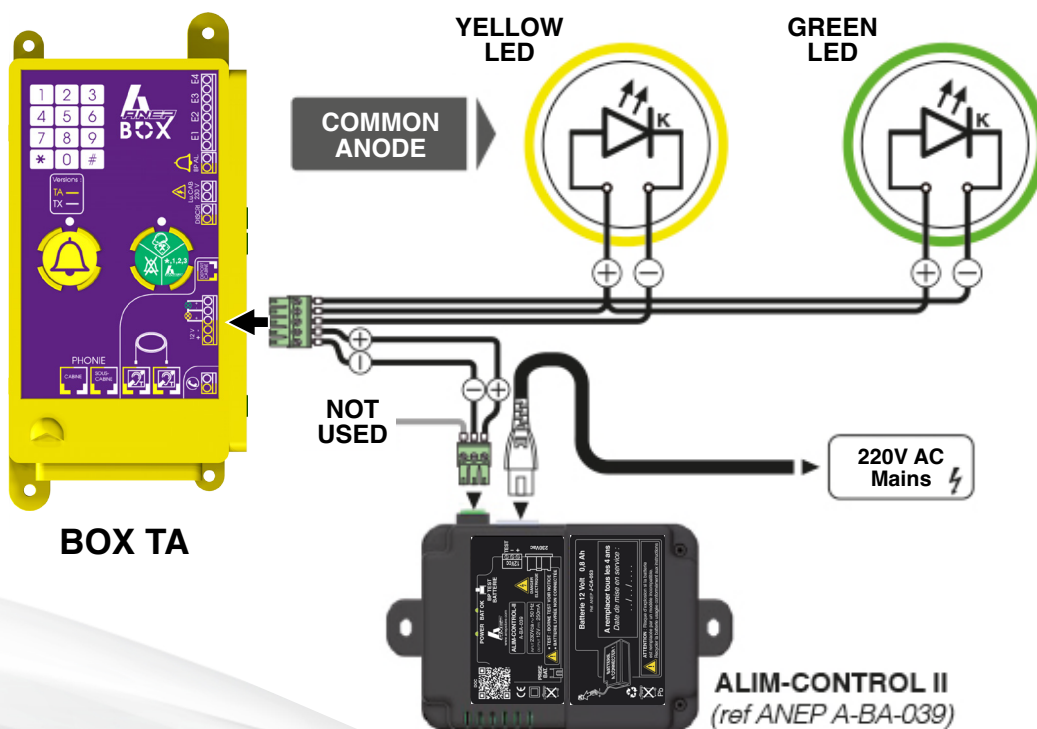

4.1 - Programming of Yellow & Green LEDs according to EN81-28 standards (2003 or 2022)

After entering the programming access code :

☞ Depending on the standard selected for indicator management, press the following keys in sequence: # 417 #, # 418 #, or # 419 #



STANDARD EN81-70 2003	OFF ●	OFF ●	Device in standby / NORMAL MODE	# 417 #
	ON ✨	OFF ●	Alarm activated, call in progress	
	OFF ●	ON ✨	In communication with a call center operator	
	OFF ●	OFF ●	Communication ended, line released, alarm acknowledged (remotely or on-site)	

STANDARD EN81-28 2022	OFF ●	OFF ●	Device in standby / NORMAL MODE	# 418 #
	ON ✨	OFF ●	Alarm activated, call in progress	
	ON ✨	ON ✨	In communication with a call center operator	
	ON ✨	OFF ●	Communication ended, line released	
	OFF ●	OFF ●	Alarm acknowledged (remotely or on-site)	
	FLASHING ✨(✨)(✨)	FLASHING (✨)(✨)	Periodic test failure	

STANDARD EN81-28 2022 YELLOW OFF	OFF ●	OFF ●	Device in standby / NORMAL MODE	# 419 #
	ON ✨	OFF ●	Alarm activated, call in progress	
	ON ✨	ON ✨	In communication with a call center operator	
	OFF ●	OFF ●	Communication ended, line released	
	OFF ●	OFF ●	Alarm acknowledged (remotely or on-site)	
	FLASHING ✨(✨)(✨)	FLASHING (✨)(✨)	Periodic test failure	

Programming via ANEP BOX Keypad

After enabling programming access mode by entering *123 :

# 417 #	Validates Yellow and Green LED behavior according to EN81-70 (2003)
# 418 #	Validates Yellow and Green LED behavior according to EN81-28 (2022)
# 419 #	Validates Yellow and Green LED behavior according to EN81-28 (2022) , with Yellow LED OFF after communication (end of alarm)

5 - PROGRAMMING

All ANEP **BOX TA** module peripherals must be connected before accessing programming mode. (Power supply, telephone line, yellow/green LEDs, magnetic loop, alarm button, discrimination, cab front panel, sub-cab module, etc.)

Grouping on a common telephone line.

All ANEP **BOX TA** and ANEP **BOX C** devices connected to the same telephone line must be connected to enable access to programming mode.

5.1 - Factory configuration

The ANEP **BOX TA** module is delivered with a set of parameters called «Factory Configuration».

SETTINGS	FACTORY CONFIGURATION
Reset settings to zero	#001#
Programming code	*123
Communication time	3 minutes
Hung up	Automatic
Periodic call frequency	3 days
Transmitter number	Factory serial number (8 digits, see label on box)
Module number	1
Phone numbers	Not programmed (empty memories)
Telephone network	Analog telephone line (RTC/PSTN)
Timer Cabin alarm button	0.5 seconds
Bt cabin alarm delay with BOX-DISCRI	25,3 seconds
Operator acquittal	Not validated
Y/G indicator management	Standard 2003 or 2022

5.2 - Programming mode

IMPORTANT :



All BOX TA parameter programming requires activation of the programming access code, with the exception of transmitter number programming. (see chapter 4.4)

5.2.1 - Access to programming

Using the ANEP **BOX TA** keypad, press the following keys :

***123** : The device emits a melody

5.2.2 - Exit Programming Mode

When you have finished programming the device,
Press the « * »

End of programming, the device emits a melody



Nota : If no key is pressed for 3 minutes, the device exits programming mode..

The device emits a melody



5.3.3 - Programming Access Code Modification

In programming mode :

#002 nnnnnnn # nnnnnnn #

Successively press the **#002**

Enter the new programming code (1 to 7 digits) and «#».

Confirm the new programming code (1 to 7 digits) and «#».



It is important to make a note of the new programmed code, as any loss of it will require the unit to be returned to the factory.

5.3 - Telephone Network Selection

5.3.1 - Analog Mode

5.3.1.1 - Analog Mode (PSTN / RTC line)

By default, the **BOX TA** module is programmed in this analog mode (Public Switched Network).

After activating the «* 123» programming access mode	
#404#	Analog telephone line (RTC / PSTN) quiescent line voltage = 28V

5.3.1.2 - Analog Mode (Private PBX)

After activating the «* 123» programming access mode	
#403#	Analog telephone line (Private PBX) standby line voltage between 20V and 28V

5.3.2 - GSM Mode

After activating the «* 123» programming access mode	
#405#	Telephone line via GSM gateway

After activating the «* 123» programming access mode	
#406#	Exit GSM mode and return to telephone line mode, public or private network

5.4 - Transmitter Number Programming (or Identifier / PROM)

The **BOX TA** module identifies itself in data mode (DTMF) by sending an identification code called «Transmitter number»..

This number corresponds to the manufacturing serial number of the BOX TA module (8 digits on the label).

To enable adaptation to the different databases of the reception centers, this identification number can be modified..

Nota : The transmitter number is numeric and has 8 digits. Example: 43 21 15 69

WARNING : modification of the transmitter number does not require prior access to programming	
--	--

* # 22220 xx xx xx xx # *

xx xx xx xx = 8 digits transmitter number
--

5.5 - Module Number Addressing Programming

After activating the «*123 » programming access mode	
---	--

303 xx

xx = Module number according to configuration type (see below)

5.5.1 - Addressing for Grouping on Analog Line

Several ANEP **BOX TA** & **BOX C** modules can be installed on the same telephone line. The **maximum configuration*** may not exceed 4 modules connected to the same telephone line. It is mandatory to configure the address of each module, so that it can be identified by the reception center. In the same way, the reception center must have created the site cards corresponding to the elevators with their module numbers (*** depends on line quality and connections**).

Configuration 1 - Remote voice in pit with BOX C

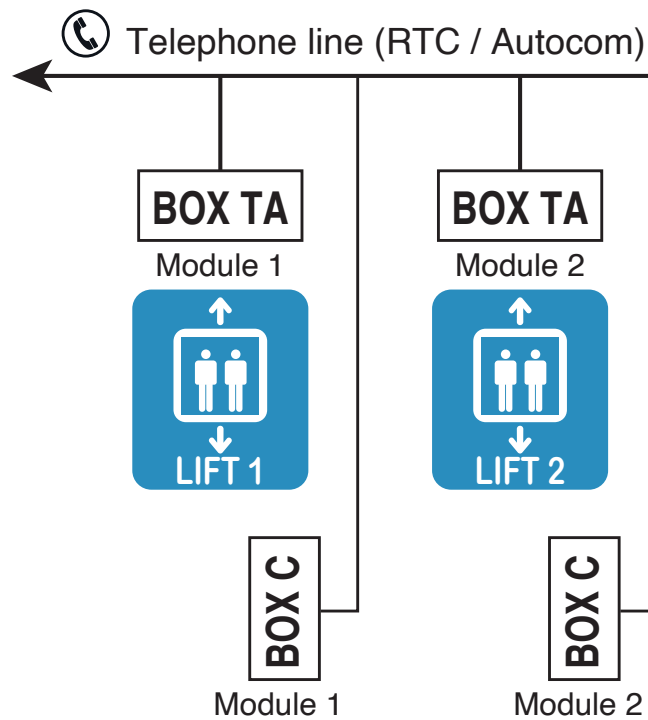

Configuration 2 - Remote under-cab voice (BOX-SC)

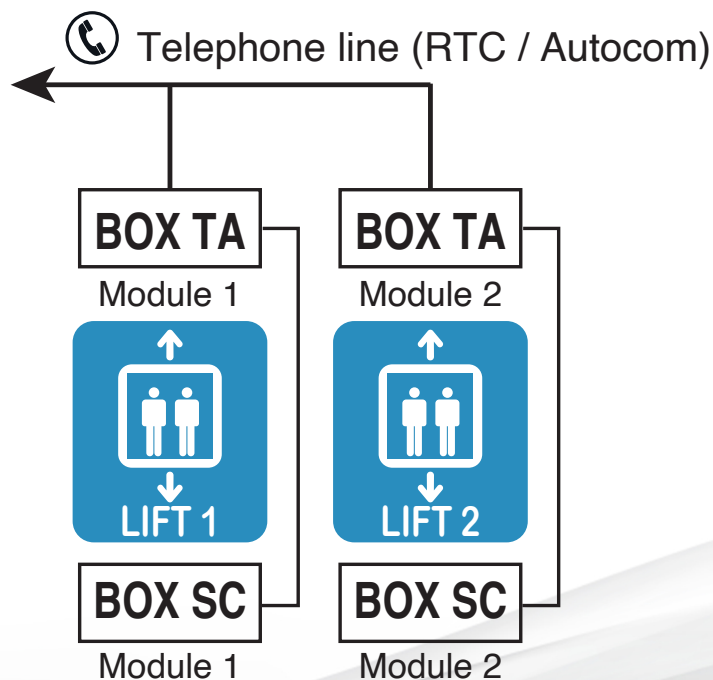

5.5.2 - Addressing for Grouping on GSM Gateway

A maximum of 2 modules can be connected when using BOX-SC units

Configuration 1 - Remote voice in pit with BOX C

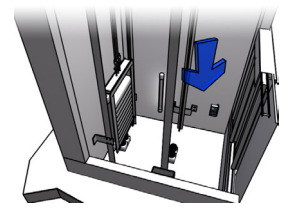
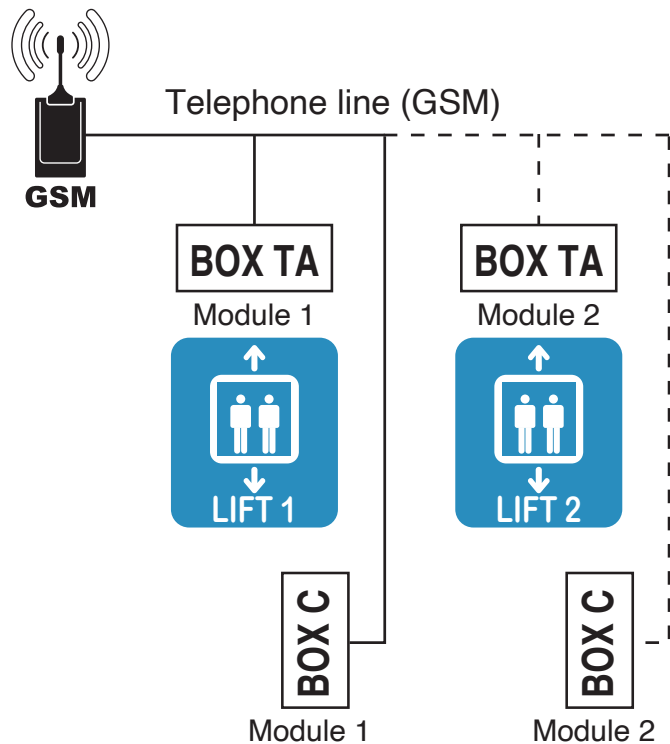

A second cabin can be connected in certain configurations. However, care must be taken to comply with the permissible cable lengths.

Configuration 2 - Remote under-cabin telephony

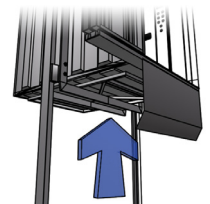
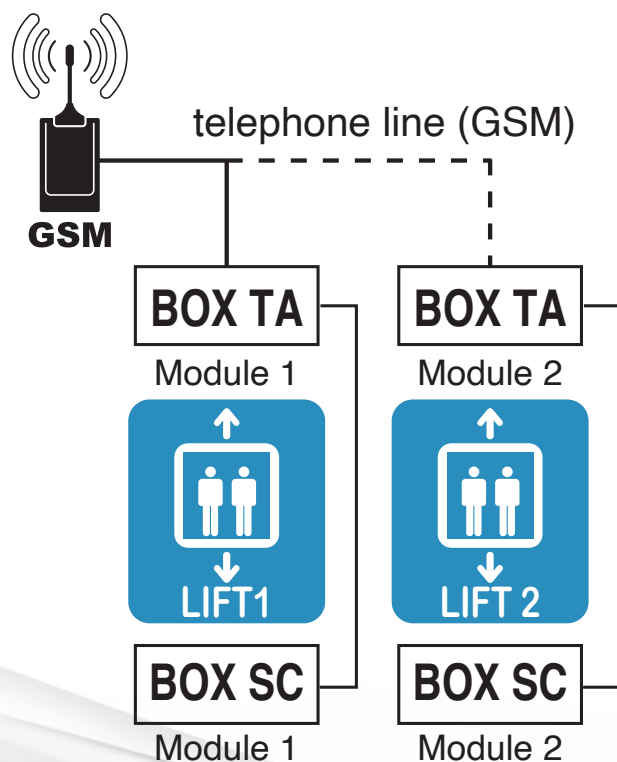

5.6 - Communication Protocol

The **BOX TA** module integrates two types of communications protocols :

- **ANEP protocol (default or factory setting) :**

Open protocol, enabling standardized data transfer for all ANEP-branded equipment

- **Protocole P100 :**

Open protocol for standardized data transfer between different brands of hardware. This type of protocol does not allow remote programming or setting of the **BOX TA** module clock. Protocol mainly used for transferring alarm-related information (limited protocol, cannot be used for products with fault and counter transfer)..

After activating the «*123» programming access mode	
# 200 0 #	ANEP protocol selection
# 200 1 #	P100 protocol selection

5.7 - Alarm Identification Method

The **BOX TA** module enables precise identification of the alarm site (elevator location) by transferring data to a central unit with automatic identification by «rising plug».

5.8 - Telephone Number Programming

5.8.1 - Telephone Number Table

MEMORY	TYPE OF INFORMATION	NATURE OF THE COMMUNICATION	INCOMING
*123 Programming access code			
#001#	Reset settings		
#101	User and technician alarms	Data & Voice	Modem or telephone
#102	User and technician alarms	Data & Voice	Modem or telephone
#104	Alarm end / GSM battery / 12 V	Data	Modem
#105	Periodic test	Data	Modem
#106	ANEPanywhere (optional)	Data	Modem
#303	Module number		
* Exit programming mode			

Note: To activate the microphone immediately when a voice call is established, add a pause (*) in front of the telephone number programmed for memories 101, 102 and 103..

Example : **#101 * 01 45 69 28 00#**

5.8.2 - Telephone Number Programming

Example of programming memory 101.

After activating the «*123» programming access mode	
# 101 xxx #	x = telephone number (max. 15 digits).

Same for other memories

5.8.3 - Pause Programming

In the case of systems connected to a private branch exchange, it is often necessary to dial a prefix followed by a pause and the call number..

To program a PAUSE (2 seconds), press the « * » key.

Example: Pause after prefix 0 (for memory 101) with the number ANEP.

After activating the «*123» programming access mode	
# 101 0 * 01 45 69 28 00 #	01 45 69 28 00 = ANEP standard number

5.8.4 - Delete a Number

Same as programming, but without entering a number.

Example: Delete number from memory 101.

After activating the «*123» programming access mode	
# 101 #	Deleting a number from memory 101

Same for other memories

5.9 - Parameter Validation and Settings

5.9.1 - 12V Monitoring Configuration

After activating the programming access mode

208 # enables 12V control function

209 # disables 12V control function

By default, the 12V control function is enabled..

5.9.2 - Cabin Alarm Button Press Delay

A time delay can be programmed, after which pressing the cabin alarm button will be detected as a real alarm. This feature prevents unwanted alarms (errors, etc.) from being triggered..

After activating the «*123» programming access mode	
# 302 n #	n = value in 1/10th of a second (max = 63)

Example: To program 4.5 seconds, enter 45 instead of nn..

Note : In factory configuration, the TA module is programmed to 0.5 seconds..

5.9.3 -Trapped passenger Call Acknowledgement (EN81-28)

When this function is enabled, an alarm call from ANEP **BOX TA** must be acknowledged by the operator by dialing «#1» on the telephone keypad during voice communication.

If this operation is not performed, ANEP **BOX TA** calls the reception center 6 times. This function ensures that the alarm is answered by an operator and not a voice mailbox.

After activating the «*123» programming access mode	
# 202 #	Validation of operator acknowledgement for cabin alarm
# 203 #	Disable operator acknowledgement for cabin alarm

5.9.4 - Communication Duration

Talk time adjustable from 1 to 99 minutes. (**Factory setting, 3 minutes**)

After activating the «*123» programming access mode	
# 201 nn #	nn = minutes Value from 01 to 99.

5.9.5 - DTMF Code Transmission Level Adjustment

After entering the programming access code, press #409 followed by a value N from 0 to 12, then #..

N	0	1	2	3	4	...	9	10	11	12
Power	-16 dBm	-15 dBm	-14 dBm	-13 dBm	-12 dBm	...	-7 dBm	-6 dBm	-5 dBm	-4 dBm

5.9.6 - Sound Level Adjustment

Methods 1

After programming, trigger a call by pressing the alarm button in the cabin for the **BOX TA** or the bell button : 

The following settings are available to adjust the sound levels and the **BOX TA** microphone/speaker switch according to local conditions :

→ Key 6 = + Key 9 = -

Adjusts the speaker volume after the microphone/speaker switch.

→ Key 5 = + Key 8 = -

Adjusts the microphone sensitivity.

Key 0 → hangs up the device

Key 1 → restores factory settings

Note: Changes made in manual adjustment mode override those previously set in automatic adjustment mode.

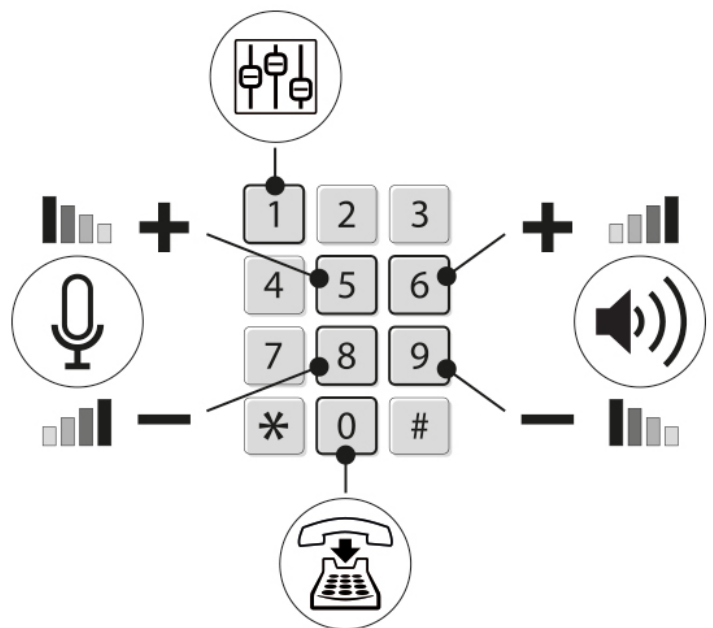

Methods 2

Settings are made outside a call, in programming mode.

Enter sequence :

- **#410 1 xx #** (between 1 and 15) to adjust cabin speaker volume
- **#410 2 xx #** (between 1 and 15) to adjust cabin roof speaker volume
- **#410 3 xx #** (between 1 and 15) to adjust under-cab loudspeaker volume

- **#411 1 xx #** (between 1 and 15) to adjust the volume of the cabin microphone
- **#411 2 xx #** (between 1 and 15) to adjust cabin roof microphone volume
- **#411 3 xx #** (between 1 and 15) to adjust under-cab microphone volume

5.9.7 - «Dual Call» Mode Configuration

Dual call mode allows you to call a guard station or security PC (voice only), before transmitting the alarm to the reception center (data and voice).

Telephone memories 101 and 102 are used for this function. Memory 103 is not used, even if a number is stored.

After activating the «*123» programming access mode	
# 206 #	Enable dual call mode
# 207 #	Disabling dual-call mode

«Telephone» memories must be set as follows:

Memory 101: Security guard or PC telephone number

Memory 102: Reception center telephone number.

Alarm sequence :

When an alarm is triggered, the transmitter calls the number in memory 101 (guard). It then calls the number in memory 102 (reception center).

If the number in memory 101 (guard or security PC) or 102 (reception center) is busy, these numbers are called up **to six times**.

5.10 - Periodic Call

5.10.1 - Enabling the Periodic Call

To validate the periodic call, a telephone number must first be programmed in memory 105 of the **BOX TA** module (see section 4.8 «Programming telephone numbers»).

NOTE: On exiting programming mode, once the periodic call telephone number has been stored, the BOX TA module automatically initiates its first periodic call..

To warn the technician that the **BOX TA** module is communicating, the loudspeaker is activated during the entire call. Access to programming mode is impossible during a telephone call..

5.10.2 - Periodicity of the Periodic Call

After activating the «*123» programming access mode	
# 301 n #	n = the number of days between each periodic call (1, 2 or 3 days)

Note: Factory configuration, 3 days.

5.11 - Intercom

5.11.1 - Gain settings in Machine Room and Firefighter Intercom Mode

Loudspeaker and microphone gains used for machinery intercom and firefighter module functions can be set independently.

These settings do not change the settings defined for traditional triphonic functions..

Microphone gain settings :

After entering the programming access code

Press **#407** then a value from 1 to 15, then **#**
(1 = minimum gain / 15 = maximum gain)

Speaker gain settings :

After entering the programming access code

Press **#408** then a value from 1 to 15, then **#**
(1 = minimum gain / 15 = maximum gain)

6 - OPERATION

6.1 - Cabin Alarm Test

Press the cabin alarm button.



If discrimination is not activated, the **BOX TA** module establishes communication with the call center operator. The tone and dialing are audible in the booth..

«Beeps» are emitted every 6 seconds if there is silence, to indicate that the device is on line..

To terminate the alarm, press the green button on the **BOX TA** module..

6.2 - Technician Alarm on Cabin Roof

Press the alarm button on the **BOX TA** module

the **BOX TA** module establishes communication with the call center operator.

The tone and dialing are audible on the cab roof. 

«Beeps» are emitted every 6 seconds in the event of silence, to indicate that the device is on line..

6.3 - Automatic Hang-up (Voice Mode)

Hang-up occurs automatically when the telephone line is busy or when the programmed call time has elapsed..

ANEP **BOX TA** emits a melody 10 seconds before the end of the call 

6.4 - Call Number Sequence

6.4.1 - Standard Mode

If the number 101 called is busy or does not answer (10 rings), ANEP **BOX TA** calls the other numbers 102 and 103 if programmed. Each programmed phone number is called a maximum of 6 times in succession..

N° Memory	Order Call	Cycles
101	1	6 Times
102	2	
103	3	

6.4.2 - Dual Call Mode

Note: Dual call mode eliminates use of memory 103.

N° Memory	Order Call	Cycles
101	1	6 Times
102	2	

When an alarm is triggered, the transmitter calls the number stored in memory 101 (guard)..

It then calls the number in memory 102 (reception center).

If the number in memory 101 (guard) or 102 (reception center) is busy, it is called up to six times..

7 - KEYBOARD PROGRAMMING TABLE

Entering and exiting parameter-setting mode

- * + <Access Code > Switch to settings mode
- * Exit programming mode

#0...

Setting

- #001# Reset of settings and Tel number
- #002...# New Access Code

#1...

Tel. number

- #101...# Main Tel number for voice call (or Guard Tel number for double calls)
- #102...# Emergency tel number for phone call (or tel for double phone call)
- #103...# Tel. number of the receiving centre to transmit data before voice transmission
- #104...# Telephone number of the receiving centre to transmit data after voice transmission
- #105...# Phone number of cyclic test call
- #106...# Internet phone number

#2...

Communication

- #200 0# ANEP protocol
- #200 1# P100 protocol
- #201...# Call duration (1 to 99 in mn)
- #202# Operator call acknowledgement function enabled
- #203# Operator call acknowledgement function not validated
- #204# Enabling Full-Duplex mode on cabs
- #205# Enable duplex mode with cab toggle
- #206# Dual Call mode (Guardian Call) enabled
- #207# Dual Call mode (Guard Call) not enabled
- #208# 12V control function enabled
- #209# 12V control function not enabled

#3...

Configuration

- #301...# Cyclic test frequency (1, 2 or 3 days)
- #302...# Alarm input acknowledgement delay (10 to 63 in 1/10 s)
- #303...# Module address (1 to 4)
- #308 XX # Forced alarm delay X is the value in ms in steps of 100ms (MAX 25.3 sec.)

#4...

Configuration

- #403# Autocom mode (Autocom private) Low line voltage (Voltage > = 20V)
- #404# Analog mode (RTC/PSTN)Normal line voltage (Voltage > = 28V)
- #405# GSM mode enabled
- #406# GSM mode not enabled
- #407...# Microphone gain setting for BOX M intercom (from 1 to 15)
- #408...# Loudspeaker gain setting for BOX M machinery intercom (from 1 to 15)
- #409...# Setting the DTMF code transmission level
- #410 1 ..# Cabin speaker volume control (from 1 to 15)
- #410 2 ..# Cabin roof speaker volume control (from 1 to 15)
- #410 3 ..# Under-cab loudspeaker volume control (from 1 to 15)
- #411 1 ..# Cabin microphone volume control (from 1 to 15)
- #411 2 ..# Cabin roof microphone volume control (from 1 to 15)
- #411 3 ..# Under-cab microphone volume control (from 1 to 15)
- #417# Enable Yellow / Green indicator management according to **2003** standards (default)
- #418# Enable Yellow / Green indicator management according to **2022** standards
- #419# Enable Yellow / Green indicator management according to **2022** standards, with yellow indicator switched off when the BOX is no longer in communication

AFTER SALES SERVICES PROVIDED BY

SAVTEL

4 bis rue de Paris 94470 Boissy-Saint-Léger

Tel : +33 (1) 45 98 34 44



Website : www.anepstore.com

